

Alu-Heckrotor Ord.No.1003/50

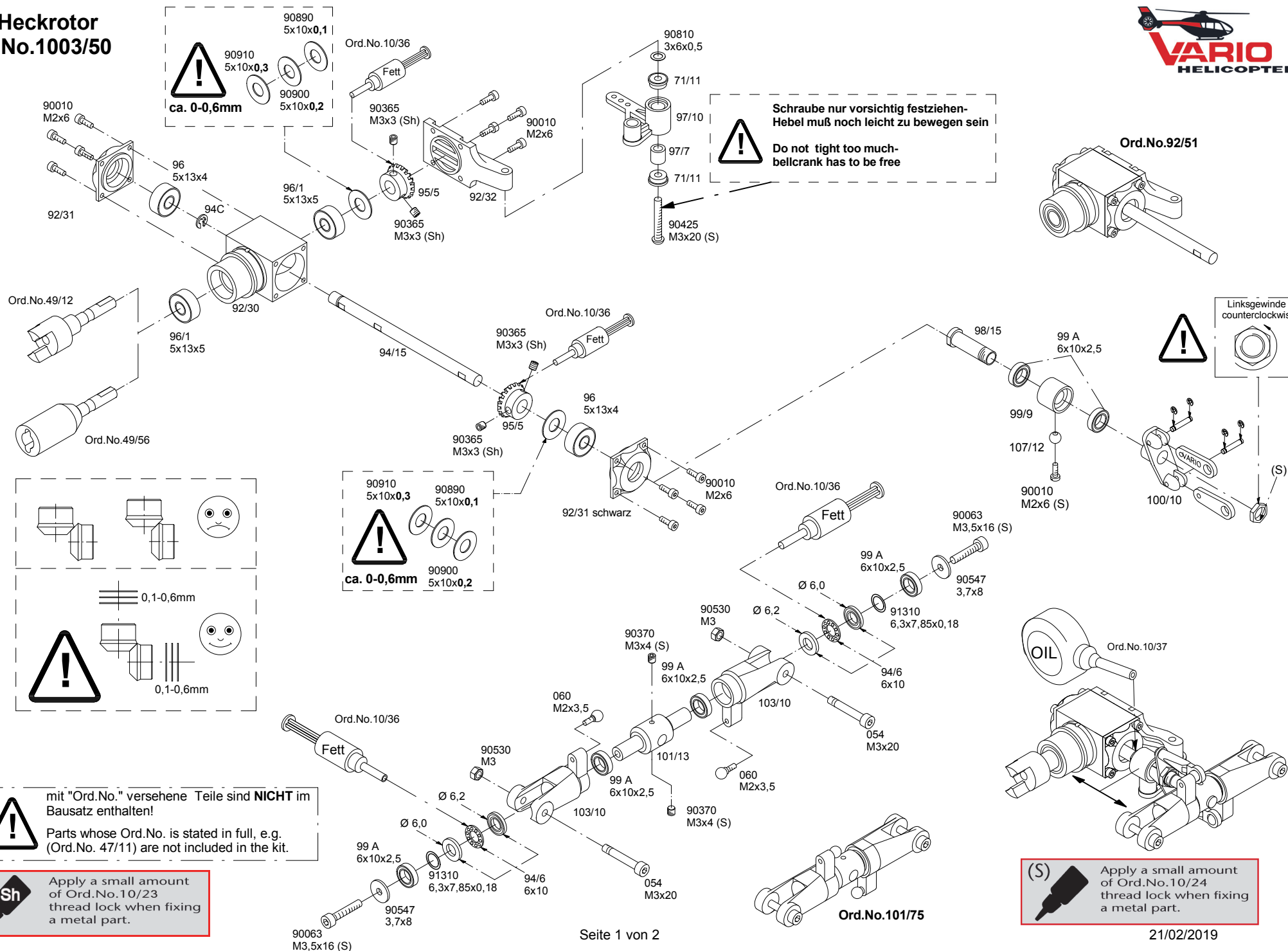

90890 5x10x0,1
90910 5x10x0,3
90900 5x10x0,2

ca. 0-0,6mm

**Schraube nur vorsichtig festziehen-
Hebel muß noch leicht zu bewegen sein**

**Do not tight too much-
bellcrank has to be free**

**Linksgewinde
counterclockwise**

0,1-0,6mm

0,1-0,6mm

90910 5x10x0,3
90890 5x10x0,1
90900 5x10x0,2

ca. 0-0,6mm

**mit "Ord.No." versehene Teile sind NICHT im
Bausatz enthalten!**

**Parts whose Ord.No. is stated in full, e.g.
(Ord.No. 47/11) are not included in the kit.**

Sh Apply a small amount
of Ord.No.10/23
thread lock when fixing
a metal part.

(S) Apply a small amount
of Ord.No.10/24
thread lock when fixing
a metal part.

Achtung:
Bei geänderter Drehrichtung benötigen Sie Ord.No. 94/2

For reversed direction use Ord.No.94/2

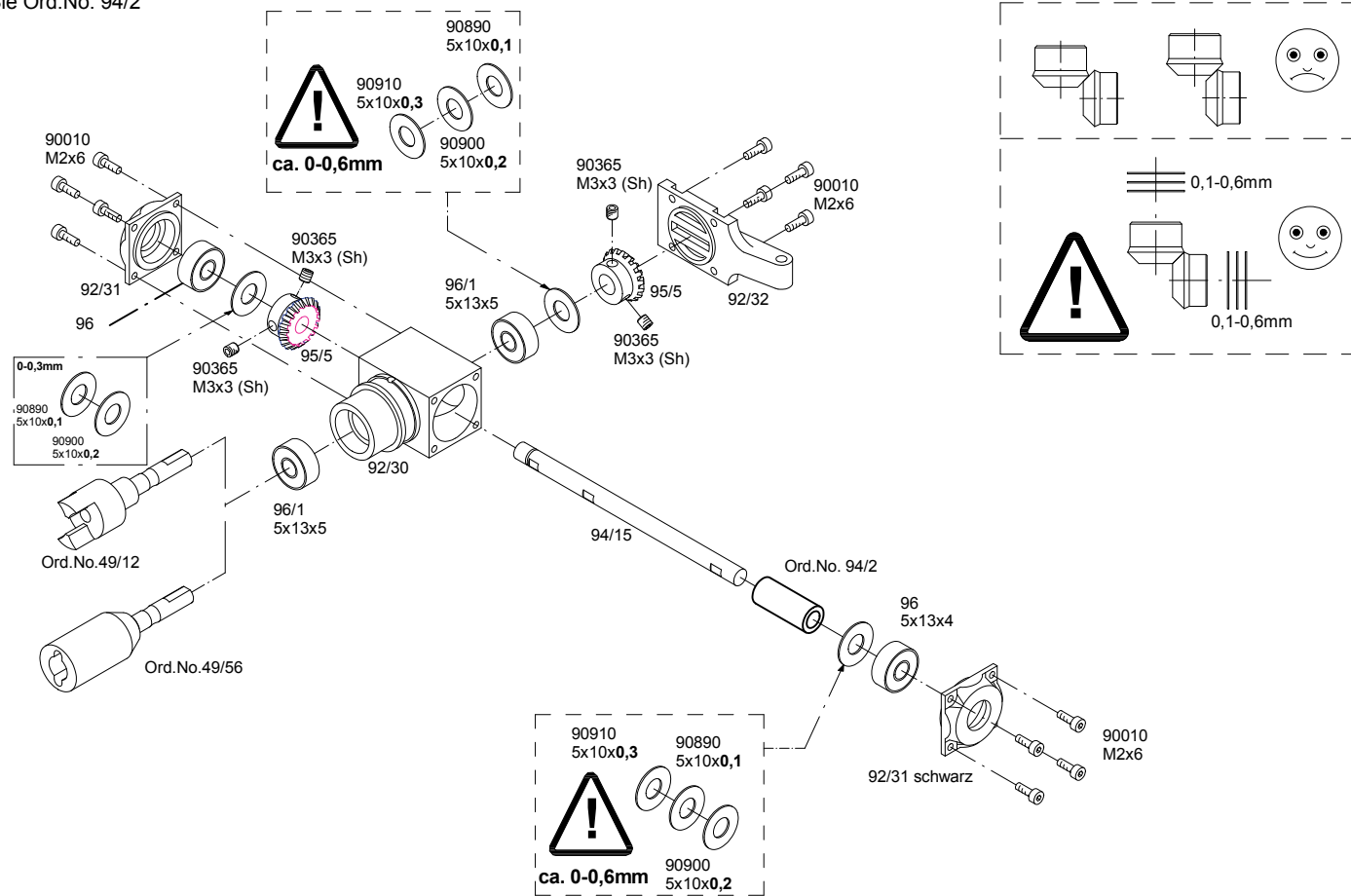

mit "Ord.No." versehene Teile sind **NICHT** im Bausatz enthalten!
Parts whose Ord.No. is stated in full, e.g. (Ord.No. 47/11) are not included in the kit.



Apply a small amount of Ord.No.10/23 thread lock when fixing a metal part.



Apply a small amount of Ord.No.10/24 thread lock when fixing a metal part.